

Cubicle Installation Guide

Range: CU Range

Panel: SGL 12.5mm BioCarbon

The panels are one-piece material with a black core therefore no edging is required. The typical edge finish is a polish & 1mm chamfer to the leading edge.

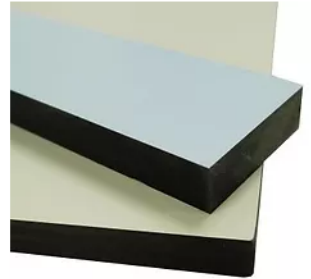

Fittings:

Anodised aluminium finish

Moving CGL Panels:

Large panels are heavy. It's recommended that any lifting should be undertaken by at least two people.

Cutting CGL Panels:

This range is bespoke therefore no cutting should be required. However, if you do, please use Tungsten-tipped tools. Finish off an edge by using a router power tool. Oil edge to leave a scratch-free shiny black finish.

Drilling CGL Panels:

Screwing into CGL is best thought of as screwing into solid steel. Always pre-drill and use an appropriate self-tapping screw. If you think you need to retract a screw, dip it in Vaseline or grease before initialling the screw.

Install time:

Depending on experience, approx 1-2 hours per door & partition.

What's already done for you:

- Support leg fitted
- Fitted pilaster to partition brackets
- Fitted rubber door stoppers
- Fitted slide bolt keep to pilasters
- Fitted sliding bolt to door
- Fitted hinges to doors

Important Information:

- Read through instructions to familiarise yourself with the system and process.
- We recommend a joiner and mate or caretaker team to install the cubicles.
- Ensure walls and floor are level and suitable for drilling into before securing the panel supporting brackets.

You will need:

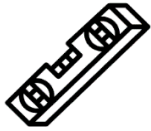

Spirit Level



Drill



Pencil



Tape Measure



Metal Saw



Screw Driver



Alan Keys



Hammer



Drill Bits:

- 3mm, 5mm, 6mm (both wood and an SDS), 8.5mm,
- 10mm & 10mm countersink drill bit to stop chipping.
- Depth Stop.

Anodised Aluminium Cubicle Fittings:



Slide Bolt and Keep Wall / Partition



Support Leg



Bracket



Door Hinge

Typical Fittings Layout

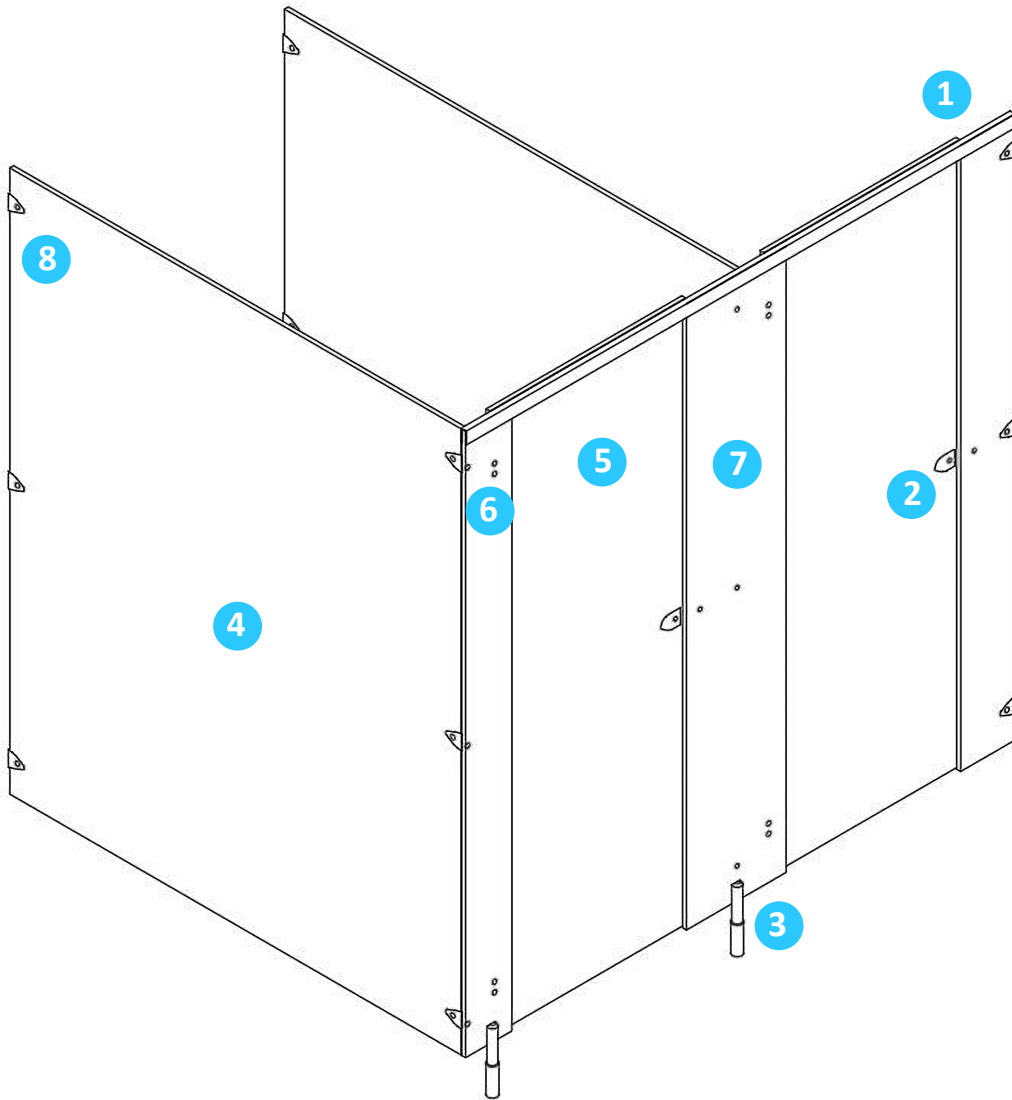

1 Headrail

2 Slide Bolt

3 Support Leg

4 Partition

5 Door

6 Door Hinges

7 Pilaster

8 Wall Bracket

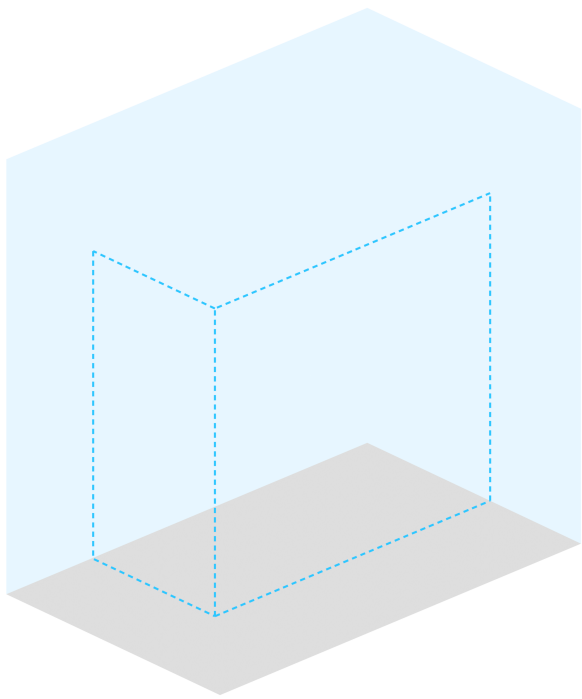

Step 1. Measuring Up

- Measure and mark off a vertical line on the back wall for the positions of the partitions.
- Then mark on the wall the positions to fix the 3 brackets.

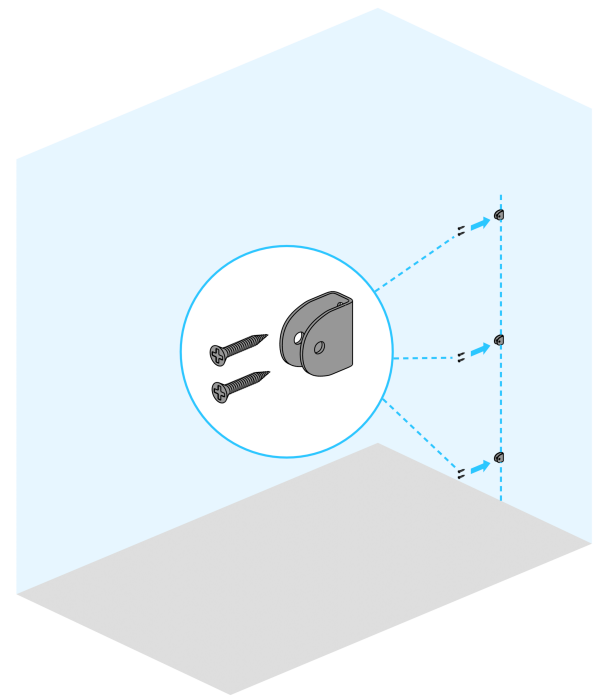

Step 2. Fitting Brackets For Partitions

- Fix 3 channel brackets per partition on the vertical line drawn on the wall.
- We recommend fixing the brackets so that 2 are 100mm from the top/bottom and 1 is at the centre of the partition.

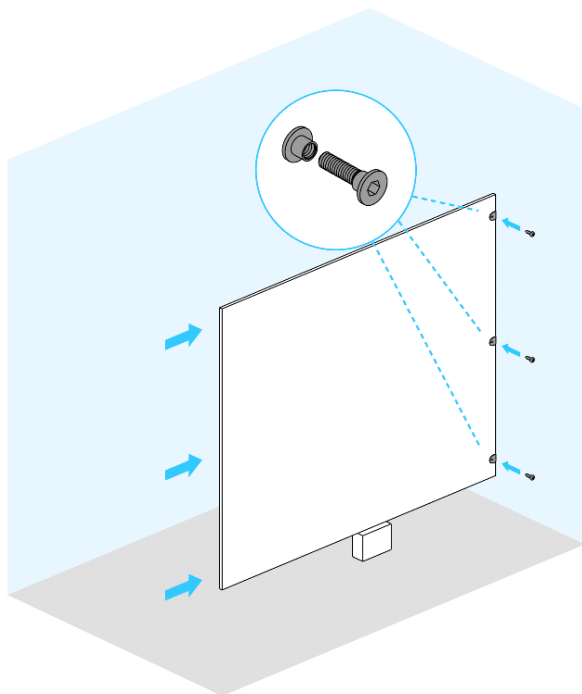

Step 3. Fitting Partitions

- Ensure the partition is level and at the correct height from the floor.
- Considering feet that are already attached to the pilasters. Drill through the holes in the partition/brackets and fix brackets to the partition. Use the male/female m6 fittings provided within the sealed bracket pack.

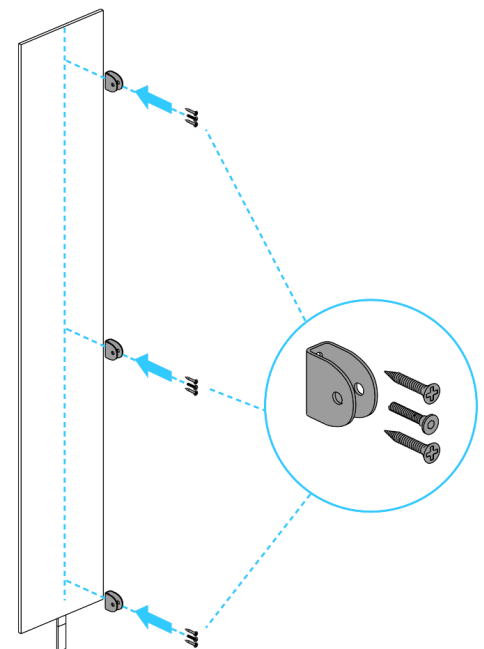

Step 4. Fitting Pilasters To Partitions

- Slide the brackets attached to the pilasters onto the partition and mark out the holes.
- Drill the holes before fixing the bracket via the m6 nuts and bolts supplied.
- Pilasters under 150mm wide do not need a foot.
- Attach the support leg to the partition (if applicable) and adjust it to the correct height.

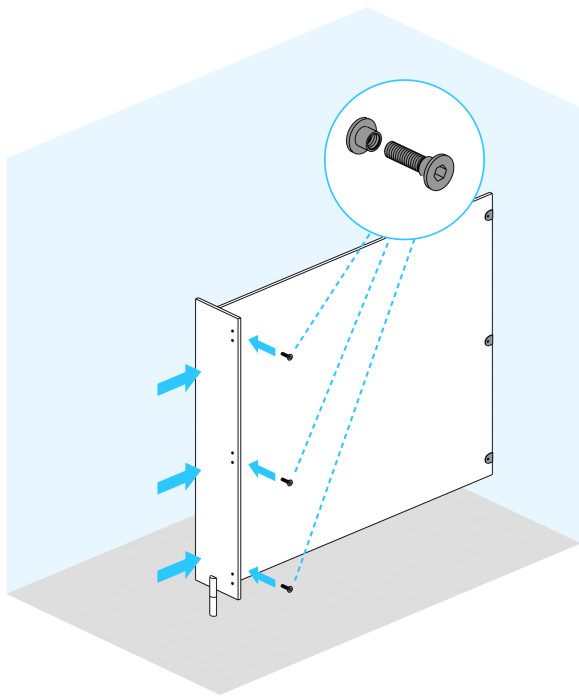

Step 5. Fixing Pilaster to Partition

- Position pilaster so the attached brackets are encompassing the partition.
- Ensure the pilaster is flush at the top and bottom.
- Then mark inside the holes of the brackets.
- Remove pilaster, drill out the holes with an 8mm bit.
- Then attach the pilaster to the partition with the m6 nuts and bolts provided.

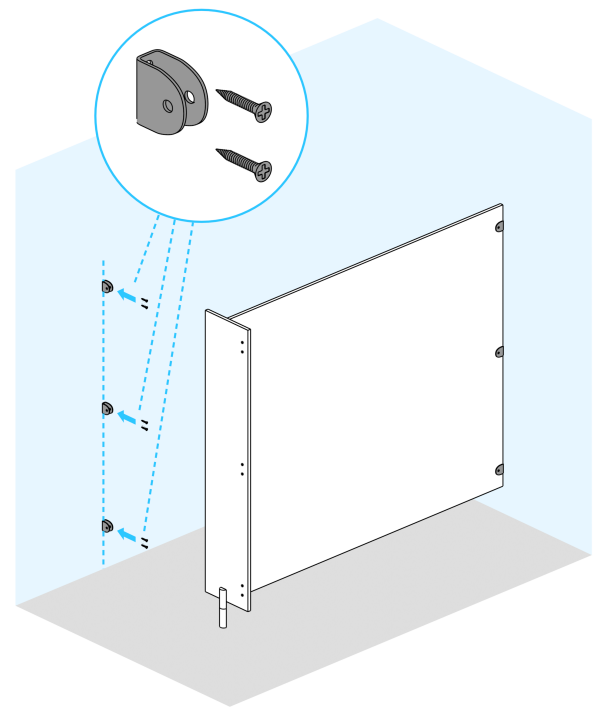

Step 6. Fixing Wall Pilasters

- Measure and mark off a vertical line on the side wall for the pilaster positions.
- Then mark the positions to fix the 3 brackets.

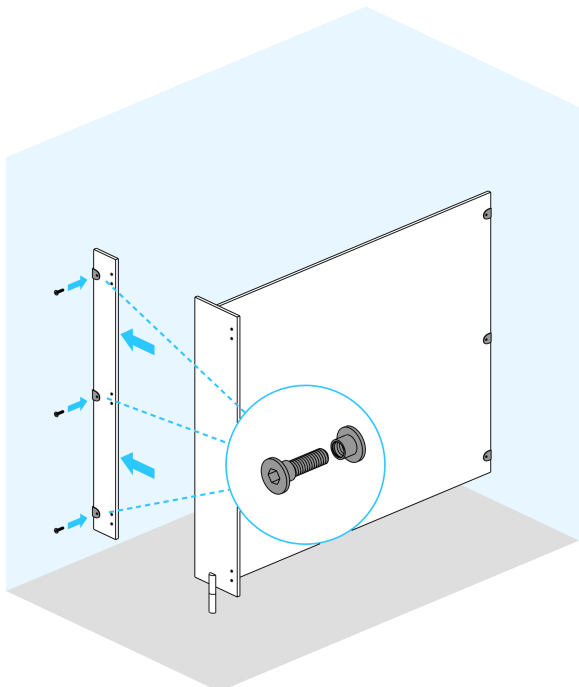

Step 7. Fixing Partition to Wall

- Slide the brackets attached to the pilasters onto the partition and mark out the holes.
- Drill the holes before fixing the bracket via the m6 nuts and bolts supplied.
- Pilasters under 150mm wide do not need a foot.
- Attach the support leg to the partition (if applicable) and adjust it to the correct height. Ensure the pilaster is aligned correctly and fix the support to the floor.

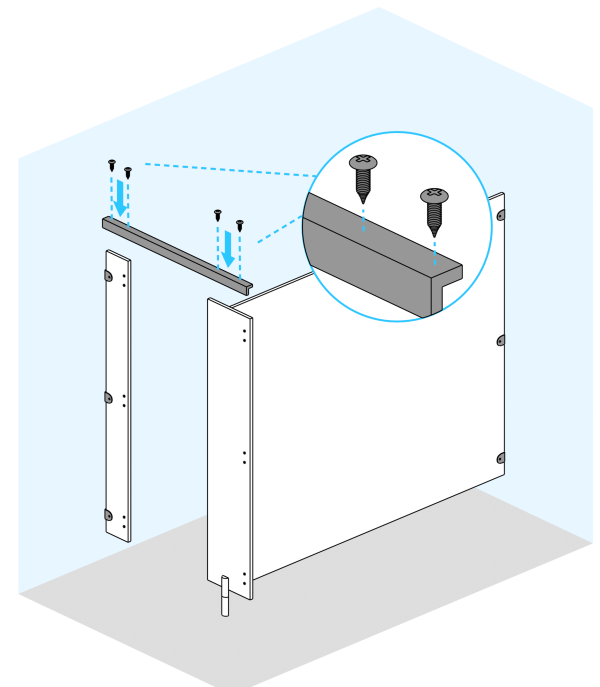

Step 8. Fitting Headrail

- With the partitions and pilasters fixed, the headrail must be placed into position over the tops of the pilasters bridging the door gap.
- Fix the headrail down onto the pilasters with the screws provided.

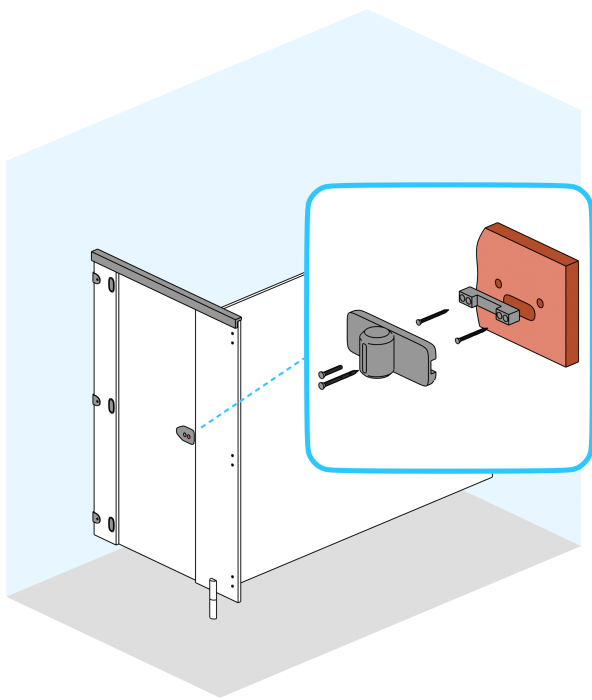

Step 9. Fitting the door

- Rest the upright door on 2 blocks so that the bottom of the door is the same level as the pilasters.
- Engage the lock so that when it's fully extended it's trapped by the keep then mark around the hinge plates.

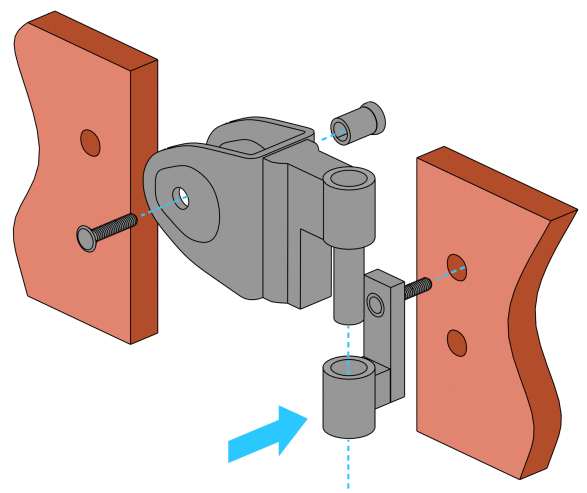

Step 10. Fixing Door Hinges

- Remove the hinge plate from hinge bracket via the PZ2 grub screw at the bottom of the hinge.
- Hold the hinge plate against the pilaster where you want the door to hang from and mark where the holes need to be drilled.
- Once the hinge plates have been fixed (via threaded bar/shoulder nut and m6 bolt/shoulder nut), you can hang the door.
- Secure the door by putting the PZ2 grub screws back in the bottom of the hinge.
- The door can be set so that it either stays open or swings closed whilst unoccupied.
- This can be achieved by pulling out and rotating the white nylon inserts, note this can only be done whilst the door is off.



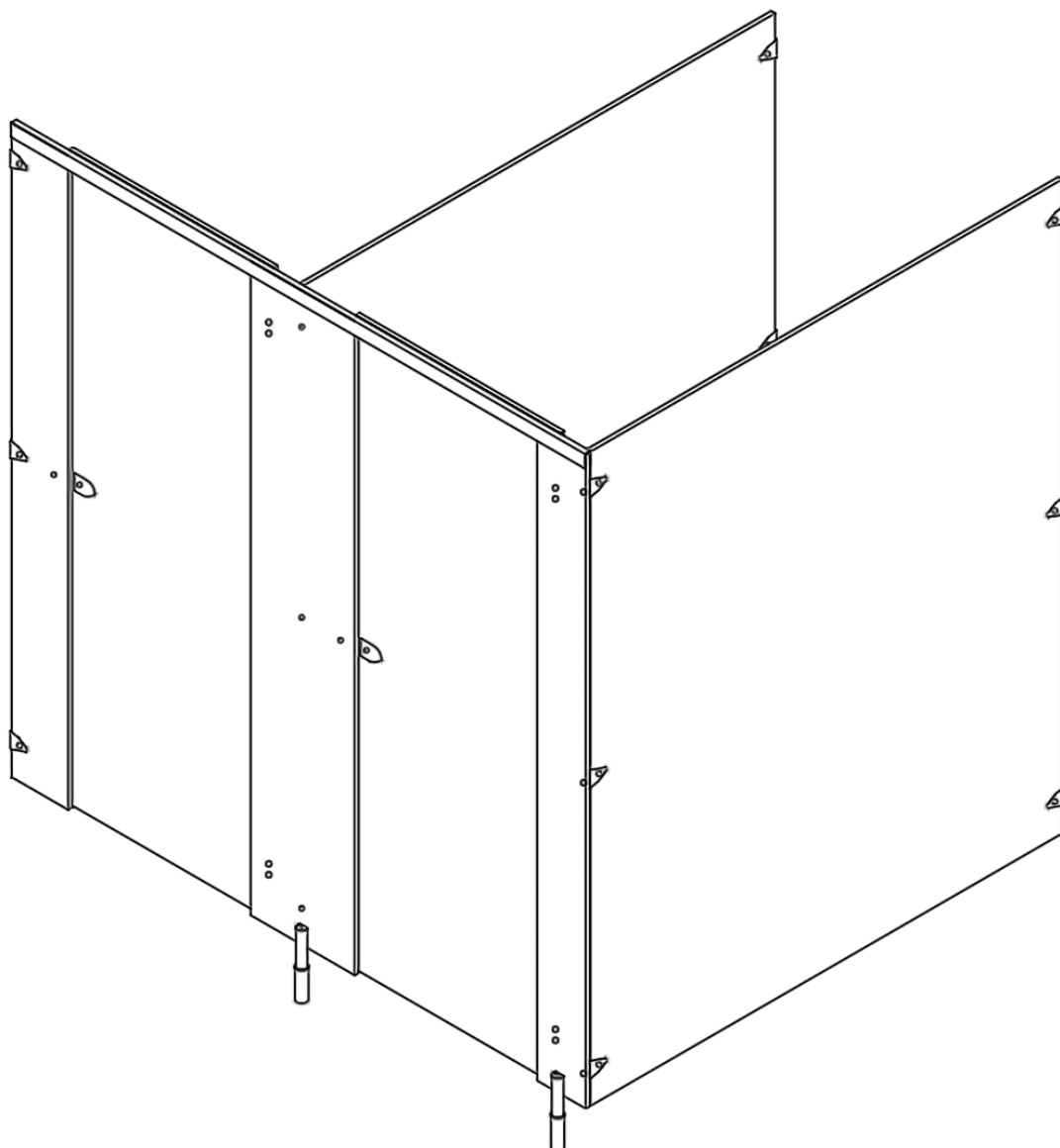

Step 11. Final Checks



Test the door and locking mechanism to make sure it has been assembled correctly.
Ensure all fixings are secure.

All steps shown here can be used to install any other cubicle configurations.



 Unit 5A, Airedale Business Park, Royd Ings Avenue, Keighley, BD21 4DG
 (01535) 602141  sales@ukcubicles.co.uk  www.ukcubicles.co.uk